

# 3 Columbus Circle

## Office Sublet Rental

57th & 58th Streets



Windows at Two-Sides



Private Windowed Office

**Jonathan Anapol**  
President  
Prime Manhattan Realty

DIRECT: 212-268-8289

MOBILE: 917-439-4225

E-MAIL: [janapol@primemanhattan.com](mailto:janapol@primemanhattan.com)

## Central Park South (West)

UNIT SIZE: 5,227 SF.

FLOOR: 24th

PRICE: Upon Request

POSSESSION: Immediate

TERM: December 2028

20 to 30 staff capacity in a highly improved built option with spectacular city views in a newly renovated building at a competitive rent. This state-of-the-art 5,227 SF. space offers high end finishes with scenic views of midtown in an environment that is modern and reflective of a top quality brand image.

- 5,227 Rentable Square Feet
- Beautiful High-end Showroom
- 1 Large, Private, Executive Office
- Built Out Open Space as combination Of Finished Ceilings & Raw Ceilings
- High Floor With Great Air, Light And Views
- Glass Door Front Entrance
- 18 Large Windows at Two Sides
- Beautiful, Well Equipped Kitchen: Dishwasher, Refrigerator Ice Maker
- Center Of Columbus Circle
- Steps From Central Park
- Class "A" Building With Strong, Quality Ownership
- Excellent Transportation Hub
- Sublease term is thru December 2028
- Great air and light with windows on both sides. Outstanding views.
- Possession is 60 days from sublease signing
- Additional storage space in basement



Open Work Area



Staff Work Area



# 3 Columbus Circle

Office Sublet Rental

57th & 58th Streets



Formerly Showroom Space



Light and Views

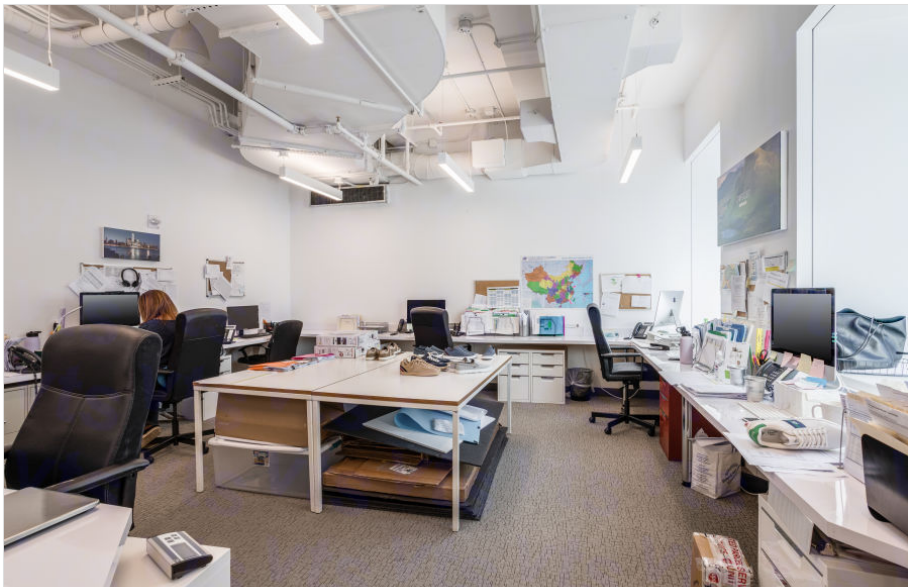

Office Work Area



Office Work Area

### 3 Columbus Circle Office Space

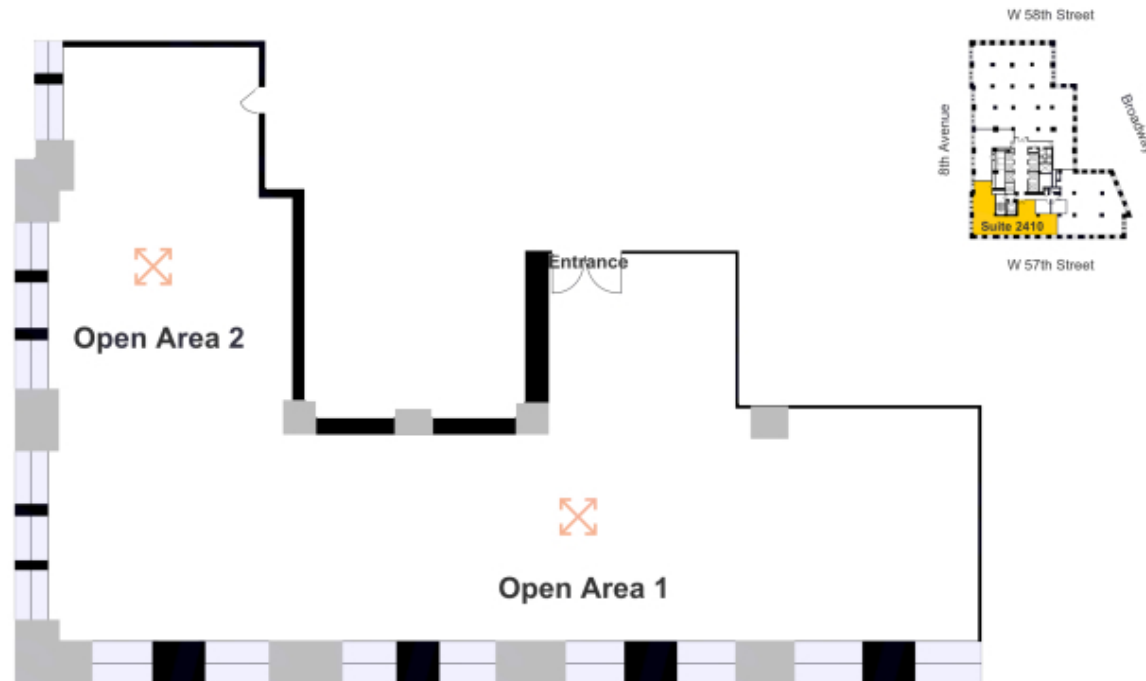

**5,227 SF. Floor Plan**



# 3 Columbus Circle

Office Sublet Rental

57th & 58th Streets

